

DOE/EA--1107-Pt.1

**Cultural Resource Survey Report
For Construction of Office Building, Driveway, and Parking
Lot at the Stanford Linear Accelerator Center**

January 1995

Submitted To:

United States Department of Energy
Oakland, California

On Behalf of:

Stanford Linear Accelerator Center
Stanford, California

Prepared By:

Michael E. Perry
Uribe and Associates
2930 Lakeshore Avenue, Suite 200
Oakland, California

With Contributions By:

Laura Jones, Ph.d
Campus Archeologist
Planning Office, Stanford University
Stanford, California

DISTRIBUTION OF THIS DOCUMENT IS UNLIMITED

MASTER

TABLE OF CONTENTS

Section	Page
EXECUTIVE SUMMARY	1
1 INTRODUCTION	2
2 SETTING	2
2.1 NATURAL SETTING	2
2.2 CULTURAL SETTING	2
3 RECORDS AND LITERATURE SEARCH	6
4 ARCHEOLOGICAL SURVEY METHODS	6
5 REPORT OF FINDINGS	6
6 RECOMMENDATIONS	6
7 REFERENCES	6

List of Figures

Figure 1. Project Vicinity Map	3
Figure 2. Project Location Map	4
Figure 3. Line Drawing of Proposed Project	5

DISCLAIMER

This report was prepared as an account of work sponsored by an agency of the United States Government. Neither the United States Government nor any agency thereof, nor any of their employees, makes any warranty, express or implied, or assumes any legal liability or responsibility for the accuracy, completeness, or usefulness of any information, apparatus, product, or process disclosed, or represents that its use would not infringe privately owned rights. Reference herein to any specific commercial product, process, or service by trade name, trademark, manufacturer, or otherwise does not necessarily constitute or imply its endorsement, recommendation, or favoring by the United States Government or any agency thereof. The views and opinions of authors expressed herein do not necessarily state or reflect those of the United States Government or any agency thereof.

DISCLAIMER

Portions of this document may be illegible in electronic image products. Images are produced from the best available original document.

**Cultural Resource Survey Report
For Construction of Office Building, Driveway, and Parking Lot
at the Stanford Linear Accelerator Center**

Executive Summary

On 30 November 1994, a records and literature search and cultural resource survey were accomplished for a proposed undertaking at the Stanford Linear Accelerator Center in Stanford, California. The proposed project involves the placement of a new building, driveway, and parking lot at the Stanford Linear Accelerator Center. The records search and cultural resource survey did not locate historic resources that are listed or eligible for listing within the National Register of Historic Places within the area of potential effect. Therefore, the Department of Energy requests that the California Office of Historic Preservation concur in a "no effect" determination for the proposed undertaking.

Qualifications: Mr. Michael E. Perry has over 14 years of archeological survey and report preparation on a wide variety of projects on federal, state, and private properties throughout California and Nevada. Doctor Jones has provided archeological surveys and documentation for the SLAC for several years. She is the Stanford University campus archeologist.

1 Introduction

Uribe and Associates has been subcontracted by the United States Department of Energy (DOE) to prepare an Environmental Assessment and associated documentation for the construction of an office building and parking lot in support of environmental management personnel activities. As part of the documentation process, the DOE determined that the proposed project constituted an undertaking as defined in Section 106 of the National Historic Preservation Act. In accordance with the regulations (36 CFR 800) implementing Section 106 of the National Historic Preservation Act, a records and literature search and historic resource identification effort were carried out on behalf of the Stanford Linear Accelerator Center (SLAC). This report summarizes cultural resource literature and record searches and a historic resource identification effort conducted by Doctor Jones of Stanford University.

The SLAC has been in continuous use for over 25 years in the study of elementary particle physics and for the development of new techniques in high energy acceleration and elementary particle detection. The proposed buildings will provide additional office space for hazardous waste management personnel. The map included as Figure 1 depicts the project location within the state of California. The map included as Figure 2 depicts the area of potential effect (APE) for the proposed undertaking. The drawing included as Figure 3 depicts the conceptual plans for the proposed construction.

2 Setting

2.1 Natural Setting

The proposed project occurs in an undeveloped area in proximity to buildings, landscaped areas, and parking lots. Tall grasses predominate throughout the project area. Unobstructed view of the ground surface is possible in most areas of the project; however, tall grasses do obscure about 20 percent of the ground surface. The project area is generally flat with little or no noticeable topography or elevation. Plant overstory is rare within the project area; however, isolated oak trees do occur relatively close to the project area. Decomposing cherts are present throughout the project area. Soils at the project site include decomposing plant and lithic materials in primarily alluvial deposition.

2.2 Cultural Setting

The region was home to hunter-gatherer groups who congregated primarily by the San Francisquito stream margins but small family groups may have seasonally transhumed through the project area to exploit both static and mobile resources. Large prehistoric village sites have been recorded along stream margins and on hillsides. These sites often included massive concentrations of flaked-stone lithic debitage and tools, house rings, food production areas, and associated midden deposits. Smaller sites in the area include lithic concentrations, resource procurement sites and campsites, and flaked or ground stone isolated materials. Historic use of the area may have included mining, ranching, and some historic settlement.

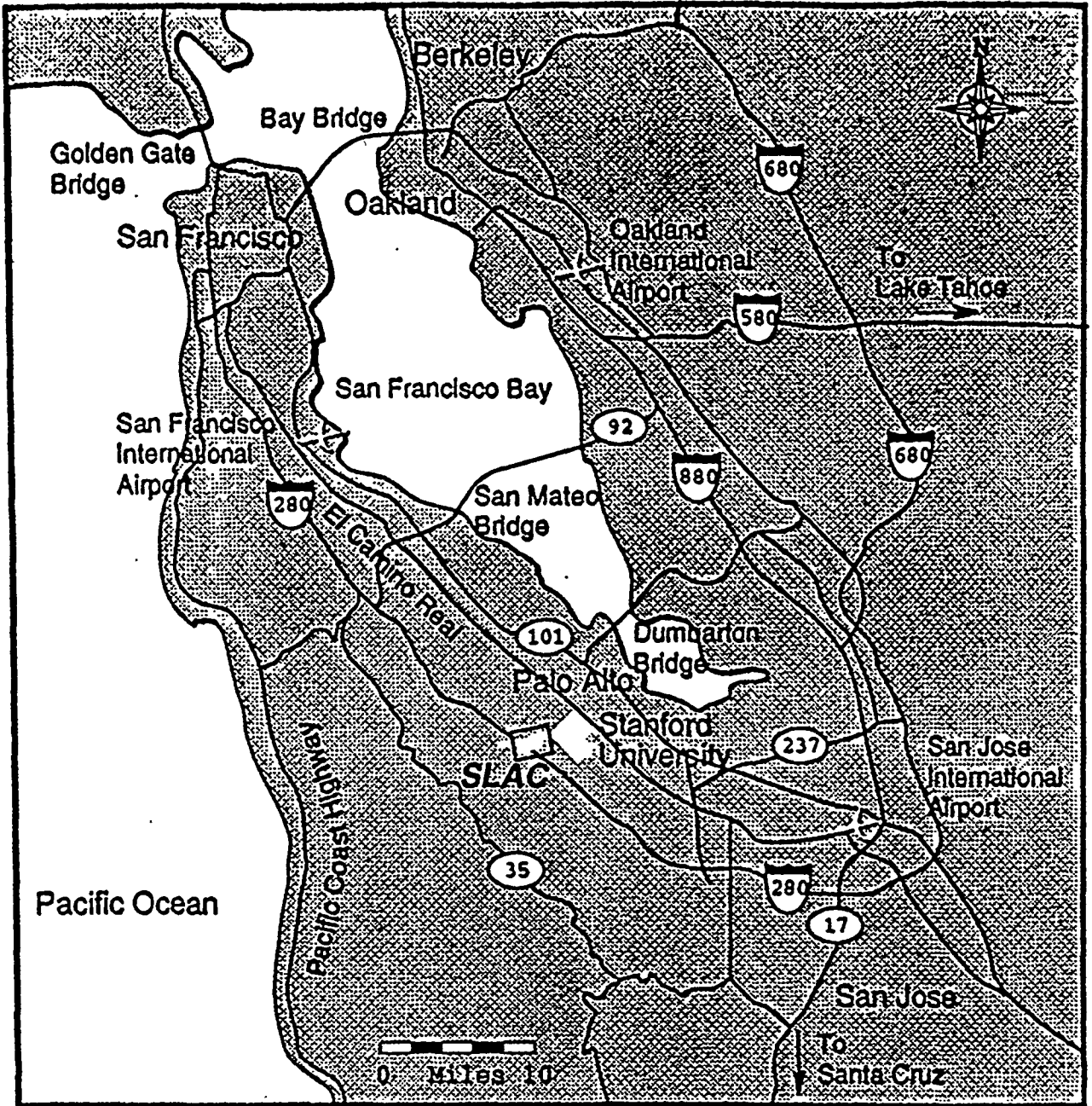

Figure 1. Project Location Map for Construction of Office Building, Driveway, and Parking Lot at SLAC

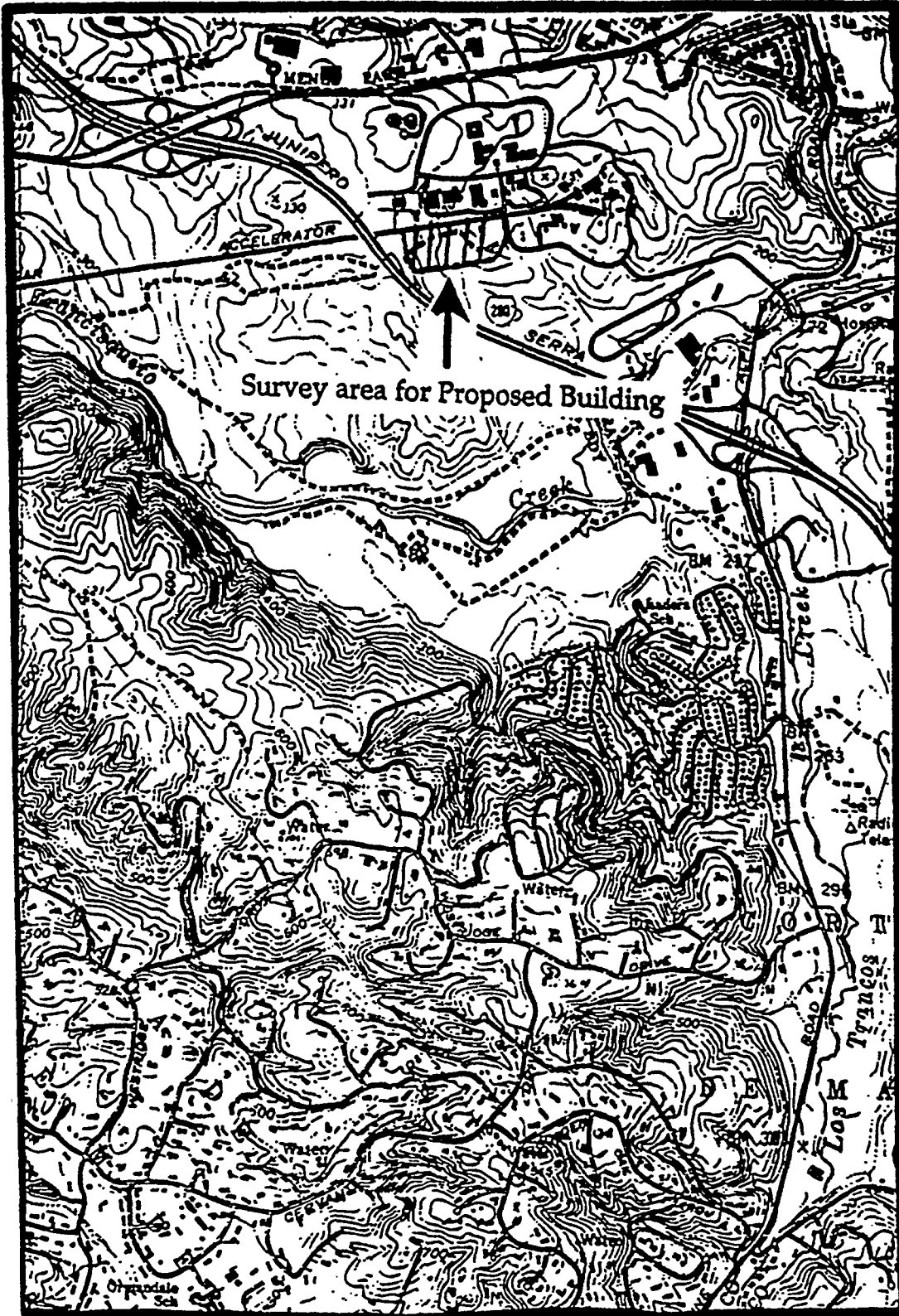

Figure 2. Area of Potential Effect for Proposed Undertaking. Portion of Palo Alto 7.5 Quadrangle.

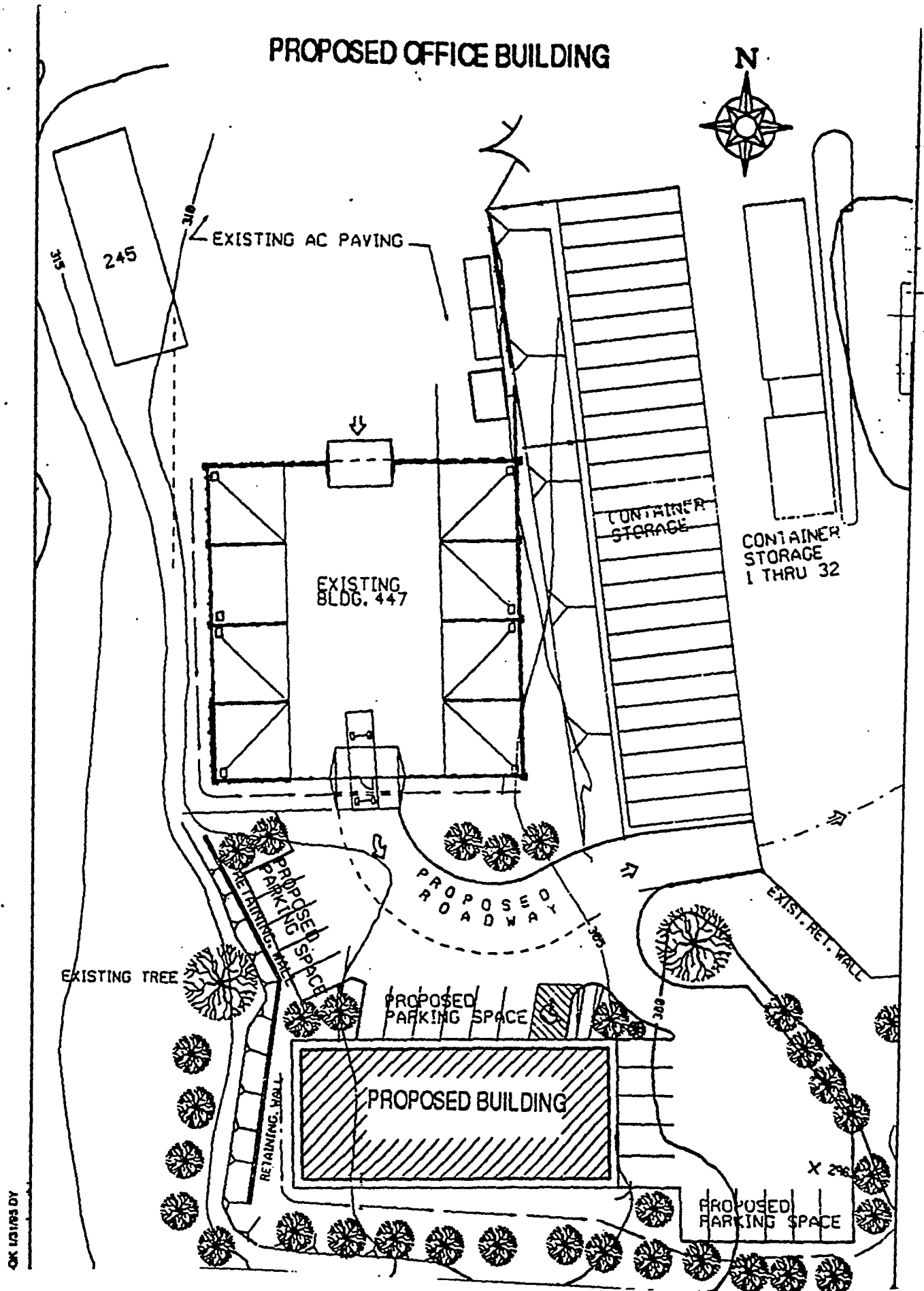

Figure 3. Line Drawing for Proposed Building, Driveway, and Parking Lot within Stanford Linear Accelerator Center

3 Records and Literature Search

A records and literature search was conducted at Stanford University for the project area and a one mile vicinity by Doctor Laura Jones, Campus Archeologist, Stanford University on 30 November 1994 (Jones, 1994a). The records available at the university mirror the archived records at the Information Center at Sonoma State University. Additionally, Doctor Jones consulted the National Register of Historic Places. Both searches revealed that previously recorded cultural resources that are eligible or listed within the National Register of Historic Places are not located within the area of potential effect or a one mile vicinity of the project area.

4 Archeological Survey Methods

Doctor Jones conducted parallel transect reconnaissance of the entire area. Survey methods met or exceeded U. S. Department of Interior guidelines and included pedestrian transects of less than 25 meters in a south to north orientation across the project area (Jones, 1994b). The project area is less than 15 acres in size. Additionally, she carefully inspected areas without ground cover to ensure that flaked-stone lithic debitage or associated cultural materials were not present. These ground inspections employed an enhanced survey methodology which included 5 meter parallel transects across areas with exposed soils (Jones, 1994b).

5 Report of Findings

Cultural materials were not found as a result of this historic resource identification effort.

6 Recommendations

Since cultural resources that are eligible or listed within the National Register of Historic Places were not found during the records search or historic resource identification effort, the DOE recommends that the California Office of Historic Preservation concur in a "no effect" determination for the proposed project. Based on the absence of historic resources within the area of potential effect and low sensitivity of the project area for prehistoric and historic cultural resources, the DOE has determined that additional protective measures such as monitoring or oversight activities during construction are not required.

7 References

Jones, Laura

1994a Personal Communications Regarding Records and Literature Searching for the location of a proposed building and parking lot at SLAC. November, 1994.

1994b Report on a Reconnaissance Survey at the Stanford Linear Accelerator Center, Proposed Environmental Safety and Health Office Buildings. On file at Uribe and Associates, Oakland, CA.

OFFICE OF HISTORIC PRESERVATION

DEPARTMENT OF PARKS AND RECREATION

P.O. BOX 942896

SACRAMENTO 94296-0001

(916) 653-6624

FAX: (916) 653-9824



(916) 653-6624
FAX (916) 653-9824

September 12, 1995

DOE950705A

Anthony J. Adduci
DEO/OAK NEPA Compliance Officer
Department of Energy
Oakland Operations Office
1301 Clay Street
OAKLAND CA 94612-5208

Re: Construction of an Office Building at the Stanford Linear
Accelerator Center, Palo Alto, Santa Clara County.

Dear Mr. Adduci:

Thank you for submitting to our office your July 3, 1995 letter and Environmental Assessment (EA) regarding the proposed construction of an office building at the Stanford Linear Accelerator Center (SLAC), Palo Alto, Santa Clara County. The proposed office building is expected to assist waste management (WM) operations at SLAC in becoming more efficient and effective. The building would be located on an undeveloped, grassy area of approximately one acre, 50 feet south of the existing Centralized Hazardous Waste Management facility, Building 447.

You are seeking our comments on your determination of the effects of the proposed project on historic resources in accordance with Section 106 of the National Historic Preservation Act (NHPA). Our review of the submitted documentation leads us to concur with your determination that the proposed project, as described, will not involve historic resources. Accordingly, your agency's responsibilities under 36 CFR 800, regulations implementing Section 106 of the NHPA, have been fulfilled. However, there may be additional Section 106 responsibilities under certain circumstances set forth in 36 CFR 800.

Thank you again for seeking our comments on your project. If you have any questions, please contact staff historian Clarence Caesar at (916) 653-8902.

Sincerely,

Cheryl Widell
State Historic Preservation Officer



Department of Energy

Oakland Operations Office

1301 Clay Street

Oakland, California 94612-5208

SEP 20 1995

Mr. Ruben Niño
Director of Engineering Services
City of Menlo Park
701 Laurel Street
Menlo Park, CA 94025

Subject: Final Environmental Assessment for the Construction and
Operation of an Office Building at the Stanford Linear Accelerator
Center.

Dear Mr. Niño:

The Environmental Assessment (EA) for the Construction and Operation of an Office Building at the Stanford Linear Accelerator Center (SLAC) has been finalized and approved. Comments received from your office were forwarded to SLAC and the applicable ones were incorporated in the Final EA. A Finding of No Significant Impact (FONSI) along with the Final EA were signed on September 8, 1995. A copy of the FONSI is enclosed. The EA is available upon request.

Should you have any questions, please call me at (510) 637-1522.

Sincerely,

A handwritten signature in black ink that reads "Robert Kong".

Robert Kong
Waste Management Division

Enclosure

cc: A. Adduci, NCO



Department of Energy

Oakland Operations Office

1301 Clay Street

Oakland, California 94612-5208

SEP 20 1995

Mr. Terry Burns
Planning Administrator
San Mateo County Planning Department
590 Hamilton Street
Redwood City, CA 94063

Subject: Final Environmental Assessment for the Construction and Operation of an Office Building at the Stanford Linear Accelerator Center.

Reference: Letter from R. Kong to T. Burns dated July 7, 1995, "Distribution of Draft Environmental Assessment for the Construction and Operation of an Office Building at the Stanford Linear Accelerator Center"

Dear Mr. Burns:

The Environmental Assessment (EA) for the Construction and Operation of an Office Building at the Stanford Linear Accelerator Center has been finalized and approved. A Finding of No Significant Impact (FONSI) along with the Final EA were signed on September 8, 1995. A copy of the FONSI is enclosed. The EA is available upon request.

Should you have any questions, please call me at (510) 637-1522.

Sincerely,

A handwritten signature in black ink that reads "Robert Kong".

Robert Kong
Waste Management Division

Enclosure

cc: A. Adduci, NCO



Department of Energy

Oakland Operations Office
1301 Clay Street
Oakland, California 94612-5208

September 12, 1995

Ms Terry Rivasplata
State Clearing House
Office of Planning and Research
1400 Tenth Street, Rm. 121
Sacramento, CA 95814

Dear Ms Rivasplata:

The Environmental Assessment (EA) for the Construction and Operation of an Office Building at the Stanford Linear Accelerator Center in Menlo Park, California has been finalized and approved. A Finding Of No Significant Impact (FONSI) along with the EA were signed on September 8, 1995. Both documents, the EA and the FONSI, are available for review upon request.

If you have any questions or need any further information please contact me or Jacqueline White at 510-637-1807 or 510-637-1972 respectively. We may also be reached at the address shown on the letter.

A handwritten signature in cursive script, appearing to read "A. Adduci".

Anthony J. Adduci
DOE/OAK NEPA Compliance Officer



Department of Energy
Oakland Operations Office
1301 Clay Street
Oakland, California 94612-5208

September 12, 1995

Rosemary Cambra
Ohlone Families Consulting Services
1845 The Alameda
San Jose, CA 95126

Dear President Cambra:

The Environmental Assessment (EA) for the Construction and Operation of an Office Building at the Stanford Linear Accelerator Center in Menlo Park, California has been finalized and approved. A Finding Of No Significant Impact (FONSI) along with the EA were signed on September 8, 1995. Both documents, the EA and the FONSI, are available for review upon request.

If you have any questions or need any further information please contact me or Jacqueline White at 510-637-1807 or 510-637-1972 respectively. We may also be reached at the address shown on the letter.

A handwritten signature in cursive script, appearing to read "A. Adduci".

Anthony J. Adduci
DOE/OAK NEPA Compliance Officer



Department of Energy

Oakland Operations Office

1301 Clay Street

Oakland, California 94612-5208

7/7/95

Mr. Terry Burns
Planning Administrator
San Mateo County Planning Department
590 Hamilton Street
Redwood City, CA 94063

Subject: Distribution of Draft Environmental Assessment for the Construction and Operation of an Office Building at the Stanford Linear Accelerator Center.

Dear Mr. Burns:

We have prepared the enclosed Draft Environmental Assessment (EA) for a proposed office building at the Stanford Linear Accelerator Center at 2575 Sand Hill Road in Menlo Park, California. The center is dedicated to research in elementary particle physics and in those fields that make use of its synchrotron facilities. Please feel free to distribute this EA to others that may have comments.

Please send written comments to:

Robert Kong
U.S. Department of Energy
Waste Management Division
1301 Clay Street, Rm. 700N
Oakland, CA 94612

before August 11, 1995.

Should you have any questions, please call me at (510) 637-1522.

Sincerely,

A handwritten signature in black ink that reads "Robert Kong".

Robert Kong
Assistant Program Manager
Waste Management Division

Enclosure



Department of Energy

Oakland Operations Office

1301 Clay Street

Oakland, California 94612-5208

7/7/95

Ms. Karen Fedrickson
Library Director
Menlo Park Library
800 Alma Street
Menlo Park, CA 94025

Subject: Distribution of Draft Environmental Assessment for the Construction and Operation of an Office Building at the Stanford Linear Accelerator Center.

Dear Ms Fedrickson:

We have prepared the enclosed Draft Environmental Assessment (EA) for a proposed office building at the Stanford Linear Accelerator Center at 2575 Sand Hill Road in Menlo Park, California. The center is dedicated to research in elementary particle physics and in those fields that make use of its synchrotron facilities. You have been listed as a repository for this EA in a newspaper advertisement. The EA may be copied without restriction.

Written comments should be sent to:

Robert Kong
U.S. Department of Energy
Waste Management Division
1301 Clay Street, Rm. 700N
Oakland, CA 94612

before August 11, 1995.

You may discard the Draft EA after that date. Should you have any questions, please call me at (510) 637-1522.

Sincerely,

A handwritten signature in cursive script that reads "Robert Kong".

Robert Kong
Assistant Program Manager
Waste Management Division

Enclosure

The Resources Agency

Pete Wilson
Governor



Douglas P. Wheeler
Secretary

of California

California Conservation Corps • Department of Boating & Waterways • Department of Conservation
Department of Fish & Game • Department of Forestry & Fire Protection • Department of Parks & Recreation • Department of Water Resources

August 3, 1995

U. S. Department of Energy
ATTN: Anthony Adduci
1301 Clay Street
Oakland, California 94612

Dear Mr. Adduci:

The State has reviewed the Environmental Assessment, for the Construction and Operation of an Office Building at the Stanford Linear Accelerator Center, San Mateo County, submitted through the Office of Planning and Research.

We coordinated review of this document with the California Highway Patrol; the Public Utilities, and State Lands Commissions; the Air Resources, California Integrated Waste Management, and San Francisco Bay Regional Water Quality Control Boards; and the Departments of Fish and Game, and Transportation.

None of the above-listed reviewers has provided a comment regarding this document. Consequently, the State will have no comments or recommendations to offer.

Thank you for providing an opportunity to review this project.

Sincerely,

A handwritten signature in cursive script that reads "Noel A. Geyer".

for James T. Burroughs
Deputy Secretary and General Counsel

cc: Office of Planning and Research
1400 Tenth Street
Sacramento, CA 95814
(SCH 95074021)

The Resources Building Sacramento, CA 95814 (916) 653-5656 FAX (916) 653-8102

California Coastal Commission • California Tahoe Conservancy • Colorado River Board of California
Energy Resources, Conservation & Development Commission • San Francisco Bay Conservation & Development Commission
State Coastal Conservancy • State Lands Commission • State Reclamation Board

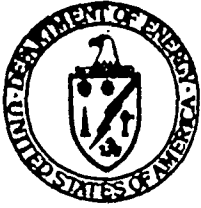

Department of Energy
Oakland Operations Office
1301 Clay Street
Oakland, California 94612-5208

JUL 03 1995

Ms. Terry Rivasplata
State Clearing House
Office of Planning and Research
1400 - 10th Street, Room 121
Sacramento, California 95814

Dear Ms. Rivasplata:

Enclosed are ten copies of the Environmental Assessment (EA) for the proposed construction of an office building at Stanford Linear Accelerator Center in Palo Alto, California, for your review and comment. A state distribution form is included with the Environmental Assessment.

This letter is to request review of the subject document by all of the cognizant California State agencies and that any and all comments be sent to this office by August 3, 1995. If there is no response by the above date, it is assumed that you have no comments.

If there are any concerns or if further information is required, please phone me at (510) 637-1807 or write to me at the above address.

Sincerely,

A handwritten signature in black ink, appearing to read "A. Adduci".

Anthony J. Adduci
DOE/OAK NEPA Compliance Officer

Enclosures

Notice of Completion

Appendix F

See NOTE below

Mail to: State Clearinghouse, 1400 Tenth Street, Sacramento, CA 95814 916/445-0613

SCH #

Project Title: OFFICE BLDG AT STANFORD ACCELERATOR

Lead Agency: US DOE/OAK

Contact Person: ANTHONY ADDUC

Street Address: 1301 CLAY ST

Phone: 510-637-1807

City: OAKLAND CA Zip: 94612

County: SAN MATEO

Project Location

County: SAN MATEO City/Nearest Community: PALO ALTO

Cross Streets: Total Acres:

Assessor's Parcel No. Section: Twp. Range: Base:

Within 2 Miles: State Hwy #: Waterways:

Airports: Railways: Schools:

Document Type

- CEQA: [] NOP [] Supplement/Subsequent [] Early Cons [] EIR (Prior SCH No.) [] Neg Dec [] Other [] Draft EIR NEPA: [] NOP [] PEA [] Draft EIS [] FONSI Other: [] Joint Document [] Final Document [] Other

Local Action Type

- [] General Plan Update [] Specific Plan [] Rezone [] Annexation [] General Plan Amendment [] Master Plan [] Prezone [] Redevelopment [] General Plan Element [] Planned Unit Development [] Use Permit [] Coastal Permit [] Community Plan [] Site Plan [] Land Division (Subdivision, Parcel Map, Tract Map, etc.) [] Other

Development Type

- [] Residential: Units _____ Acres _____ [] Office: Sq.ft _____ Acres _____ Employees _____ [] Commercial: Sq.ft _____ Acres _____ Employees _____ [] Industrial: Sq.ft _____ Acres _____ Employees _____ [] Educational _____ [] Recreational _____ [] Water Facilities: Type _____ MGD [] Transportation: Type _____ [] Mining: Mineral _____ [] Power: Type _____ Watts [] Waste Treatment: Type _____ [] Hazardous Waste: Type _____ [] Other: _____

Project Issues Discussed in Document

- [x] Aesthetic/Visual [x] Flood Plain/Flooding [] Schools/Universities [] Water Quality [] Agricultural Land [] Forest Land/Fire Hazard [] Septic Systems [] Water Supply/Groundwa [] Air Quality [x] Geologic/Seismic [x] Sewer Capacity [] Wetland/Riparian [x] Archeological/Historical [] Minerals [] Soil Erosion/Compaction/Grading [x] Wildlife [] Coastal Zone [x] Noise [] Solid Waste [] Growth Inducing [] Drainage/Absorption [] Population/Housing Balance [] Toxic/Hazardous [x] Landuse [] Economic/Jobs [] Public Services/Facilities [x] Traffic/Circulation [x] Cumulative Effects [] Fiscal [] Recreation/Parks [x] Vegetation [] Other: E.D.

Present Land Use/Zoning/General Plan Use

Project Description

NOTE Clearinghouse will assign identification numbers for all new projects. If a SCH number already exists for a project (e.g. from a Notice of Pre or previous draft document) please fill it in. Revised Print



Department of Energy

Oakland Operations Office

1301 Clay Street

Oakland, California 94612-5208

JUL 03 1995

State of California
Department of Parks and Recreation
Office of Historic Preservation
1416 - 9th Street
Sacramento, California 94296-0001
Attn: Clarence Caesar

Dear Mr. Caesar:

Enclosed is a copy of the Environmental Assessment for the proposed construction of an office building at Stanford Linear Accelerator Center in Palo Alto, California, for your review and comment. We ask that any and all comments be sent to this office by August 3, 1995. If there is no response received by the above date, it is assumed that you have no comments.

If you have any questions or need any further information, please contact me at (510) 637-1807 or at the address on this letter.

Sincerely,

A handwritten signature in black ink, appearing to read "A. Adduci".

Anthony J. Adduci
DOE/OAK NEPA Compliance Officer

Enclosure



Department of Energy

Oakland Operations Office

1301 Clay Street

Oakland, California 94612-5208

JUL 03 1995

Rosemary Cambra, President
Ohlone Families Consulting Services
1845 The Alameda
San Jose, California 95126

Dear President Cambra:

Enclosed is a copy of the Environmental Assessment for the proposed construction of an office building at Stanford Linear Accelerator Center in Palo Alto, California, for your review and comment. We ask that any and all comments be sent to this office by August 3, 1995. If no response has been received by the above date, it will be assumed that you have no comments.

Should you have any questions or require further information regarding this effort, please phone me at (510) 637-1807 or write to me at the above address.

Sincerely,

A handwritten signature in cursive script, appearing to read "A. Adduci".

Anthony J. Adduci
DOE/OAK NEPA Compliance Officer

Enclosure